

Soils Map

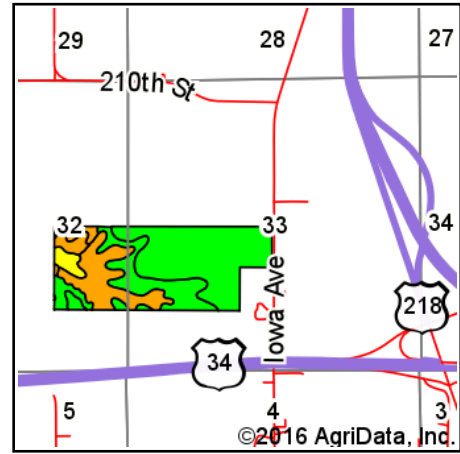

State: **Iowa**
 County: **Henry**
 Location: **33-72N-6W**
 Township: **Marion**
 Acres: **127.12**
 Date: **11/11/2016**

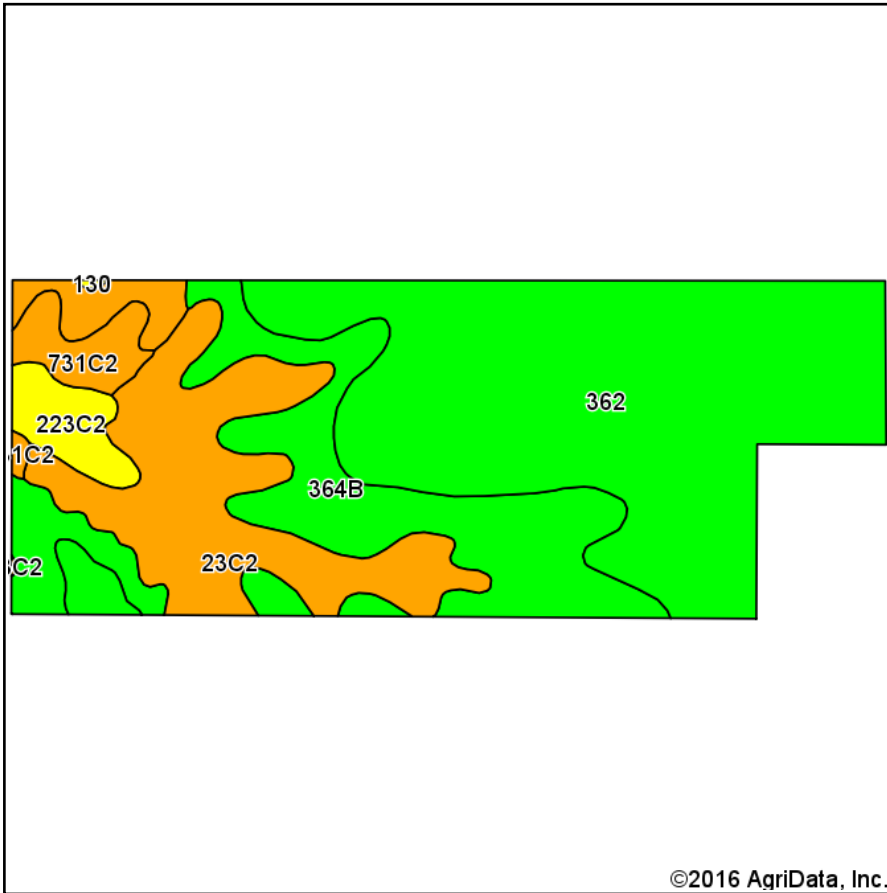

Maps Provided By:



© AgriData, Inc. 2016

www.AgriDataInc.com



Area Symbol: IA087, Soil Area Version: 20

| Code | Soil Description | Acres | Percent of field | CSR2 Legend | Non-Irr Class *c | CSR2** | CSR |
|-------------------------|--|-------|------------------|-------------|------------------|-------------|-------------|
| 362 | Haig silt loam, 0 to 2 percent slopes | 62.09 | 48.8% | | IIw | 83 | 70 |
| 364B | Grundy silt loam, 2 to 5 percent slopes | 28.89 | 22.7% | | Ile | 74 | 75 |
| 23C2 | Arispe silty clay loam, 5 to 9 percent slopes, moderately eroded | 24.28 | 19.1% | | IIIe | 62 | 50 |
| 223C2 | Rinda silty clay loam, 5 to 9 percent slopes, moderately eroded | 4.28 | 3.4% | | IVw | 45 | 22 |
| 731C2 | Pershing silty clay loam, 5 to 9 percent slopes, moderately eroded | 4.20 | 3.3% | | IIIe | 62 | 45 |
| 131B | Pershing silt loam, 2 to 5 percent slopes | 3.29 | 2.6% | | IIIe | 70 | 67 |
| 130 | Belinda silt loam, 0 to 2 percent slopes | 0.09 | 0.1% | | IIIw | 47 | 63 |
| Weighted Average | | | | | | 74.6 | 64.8 |

Area Symbol: IA087, Soil Area Version: 20

**IA has updated the CSR values for each county to CSR2.

*c: Using Capabilities Class Dominant Condition Aggregation Method

Soils data provided by USDA and NRCS.